

## LOCATION

SCALE 1:4000

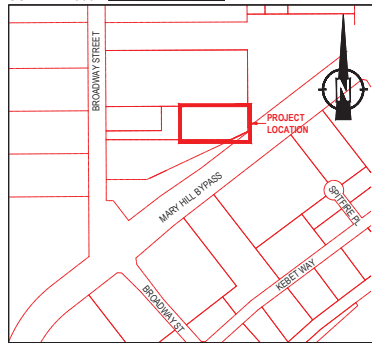

## TYPICAL SNAG PLACEMENT DETAIL

N.T.S.

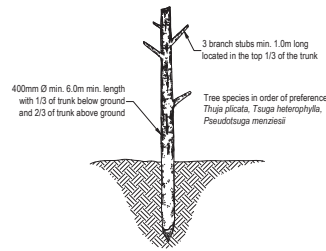

## PLAN

SCALE 1:250

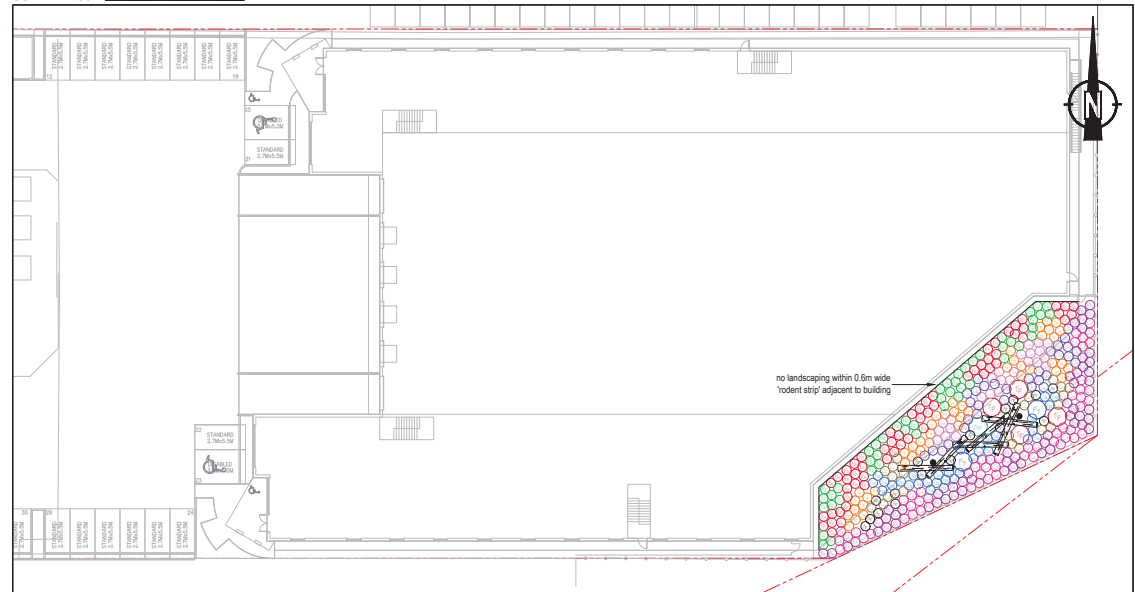

## PLANT SPECIES LIST AND SPECIFICATIONS

SYMBOL	COMMON NAME	LATIN NAME	NUMBER	COMMENTS
	broadleaf maple	<i>Acer macrophyllum</i>	1	2.0m container grown (min. no. 7 pot); densely branched; well established
	Sitka spruce	<i>Picea sitchensis</i>	2	2.0m container grown (min. no. 7 pot); densely branched; well established
	western redcedar	<i>Thuja plicata</i>	4	2.0m container grown (min. no. 7 pot); densely branched; well established
	red alder	<i>Alnus rubra</i>	16	no. 2 pot; densely branched; well established
	beaked hazelnut	<i>Corylus cornuta</i>	21	no. 2 pot; densely branched; well established
	Indian plum	<i>Osmaronia cerasiformis</i>	30	no. 2 pot; densely branched; well established
	Nootka rose	<i>Rosa nutkana</i>	59	no. 2 pot; multi-stemmed; densely branched; well established
	red elderberry	<i>Sambucus racemosa</i>	45	no. 2 pot; densely branched; well established
	red-osier dogwood	<i>Cornus stolonifera</i>	53	no. 2 pot; densely branched; well established
	salal	<i>Gaultheria shallon</i>	25	no. 2 pot; multi-stemmed; well established
	salmonberry	<i>Rubus spectabilis</i>	56	no. 2 pot; multi-stemmed; well established
	snowberry	<i>Symphoricarpos albus</i>	32	no. 2 pot; densely branched; well established
	thimbleberry	<i>Rubus parviflorus</i>	48	no. 2 pot; multi-stemmed; densely branched; well established
	snag	Min. 15% composition of the following:	2	400mm Ø min.; 6.0m min. in length; 1/3 below ground; 2/3 above ground
	woody debris	<i>Pseudotsuga menziesii</i> <i>Populus trichocarpa</i> <i>Acer macrophyllum</i>	6	3.0m - 5.0m in length; 300mm Ø min.

## TYPICAL LOG ON LOG DETAIL

N.T.S.

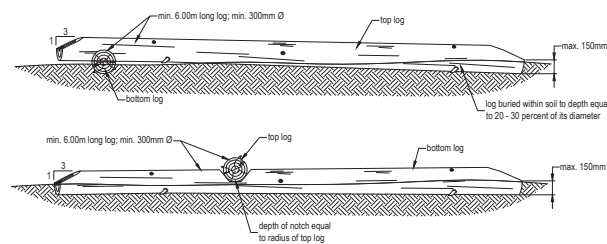

## TYPICAL CONTAINER SHRUB AND NO. 2 POT TREE PLANTING DETAIL

N.T.S.

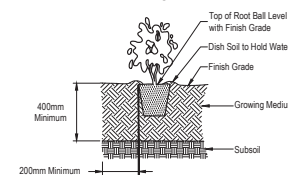

## TYPICAL CONTAINER (No. 7 POT) TREE PLANTING DETAIL

N.T.S.

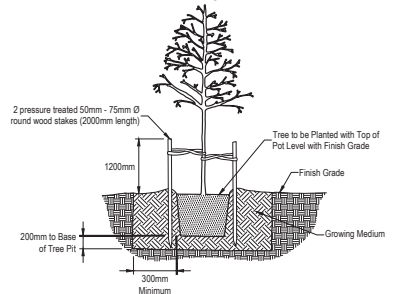

## GENERAL LANDSCAPE SPECIFICATIONS

- Plant materials and the planting of such materials are to be in accordance with the British Columbia Landscape Standard (latest edition) jointly published by the British Columbia Society of Landscape Architects and the British Columbia Landscape Nursery Association.
- All works are to be conducted in accordance with the sediment control provisions of the "Standards and Best Practices for Instream Works" (Ministry of Water, Land & Air Protection, 2004).
- All plant materials are to be inspected and approved by Envirowest prior to installation.
- Growing medium is to be free of any subsoils, roots, noxious grass, weeds, toxic materials, stone over 30 mm diameter, foreign objects, and possess an acidity range (pH) of 5.5 to 7.5. Growing medium is to be inspected by Envirowest prior to placement.
- All blackberry (*Rubus* sp.) and *R. laciniatus* is to be cleared and grubbed from project site.
- All debris and/or excess material from landscape operations are to be collected and disposed offsite in accordance with all regulatory requirements.
- Disturbed areas to be seeded with red fescue (*Festuca rubra*) augmented with fireweed (*Epilobium angustifolium*) and goldenrod (*Solidago canadensis*) seed; percentage composition and application rate of final seed mix to be determined by Envirowest.
- All plants must be of native stock; any cultivars are not to be planted.
- The developer is to provide three (3) years of plant maintenance. Plant maintenance is to include watering, selective pruning and clearing of blackberry. Species survivorship is to equal one-hundred (100) percent three (3) years from planting. Replacement of dead stock may be required to fulfill this specification. Replacement stock is also subject to one-hundred (100) percent survivorship three (3) years from planting.

## REFERENCE DRAWINGS

- Email: 1. site plan 1 rev per 15m setback july04.19.dwg. Received July 05, 2019; Wales McLelland Construction.
- Email: Legal.dwg. Received November 22, 2004; Clitwest Consultant Ltd.

WALES MCLELLAND CONSTRUCTION

1560 BROADWAY STREET  
Port Coquitlam, BC



envirowest consultants inc.

Suite 101 - 1515 Broadway Street  
Port Coquitlam, British Columbia  
Canada V3C 6M2  
office: 604-944-0502  
facsimile: 604-944-0507

[www.envirowest.ca](http://www.envirowest.ca)

## LANDSCAPE PLAN LANDSCAPE DETAILS AND SPECIFICATIONS

DESIGN: IWW	DRAWN: CEV	CHECKED: RWS	REVISION: 01	REVISION DATE: July 16, 2019
SCALE: As Shown	DATE: October 10, 2018	DRAWING NUMBER: 1278-05-01		