

#### OPTION 1 2-WAY, 2-SIDED PARALLEL PARKING

- STREETSCAPE SUMMARY**
- TWO WAY VEHICLE TRAFFIC
  - PARALLEL PARKING BOTH SIDES
  - PARKING SPACES: 36
  - MULTI-USE PATH ON SOUTH SIDE, SIDEWALK ON NORTH SIDE
  - MID-BLOCK PEDESTRIAN CROSSING AND NEW PUBLIC PLAZA ON NORTH SIDE OF STREET
  - STREET TREES, BOLLARDS AND FURNISHINGS IN BOULEVARD SPACES

- POSITIVES**
- MINIMAL TRAFFIC IMPACT (MAINTAINS TWO WAY TRAVEL)
  - ACCOMMODATES ALL USERS
  - ENHANCED STREETSCAPE
  - OPPORTUNITIES FOR RAINGARDENS IN LARGE PLANTING BEDS

- NEGATIVES**
- PARKING LOSS (20 FEWER SPACES THAN EXISTING NUMBER)

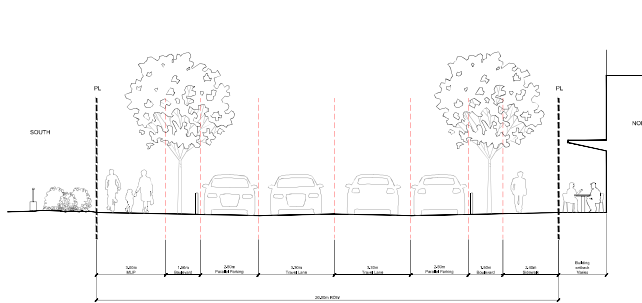



## OPTION 2 1-WAY, 1-SIDED ANGLED PARKING

- STREETSCAPE SUMMARY**
- ONE WAY VEHICLE TRAFFIC (EAST BOUND)
  - ANGLED PARKING ON NORTH SIDE
  - PARKING SPACES: 42
  - MULTI-USE PATH ON SOUTH SIDE, SIDEWALK ON NORTH SIDE
  - MID-BLOCK PEDESTRIAN CROSSING AND NEW PUBLIC PLAZA ON NORTH SIDE OF STREET
  - STREET TREES, BOLLARDS AND FURNISHINGS IN BOULEVARD SPACES

- POSITIVES**
- ACCOMMODATES ALL USERS
  - ENHANCED STREETSCAPE
  - NORTH SIDEWALK AND CAFE SPACES WELL BUFFERED FROM ROADWAY
  - OPPORTUNITIES FOR HANGGARDENS IN LARGE PLANTING BEDS

- NEGATIVES**
- TRAFFIC IMPACT (NO WEST BOUND TRAVEL)
  - PARKING LOSS (16 FEWER SPACES THAN EXISTING NUMBER)
  - NO WEST BOUND BUS TRAFFIC OR STOP (EAST BOUND POSSIBLE WITH LOADING ON ROADWAY OR STOP ALCOVE AT VETERANS PARK)
  - OVERLY WIDE NORTH SIDEWALK (OUT OF SCALE TO ANTICIPATED PEDESTRIAN VOLUMES AND USES)

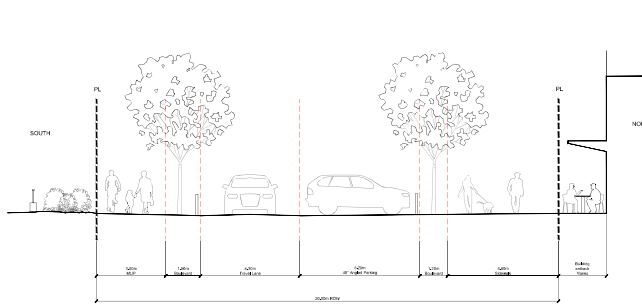



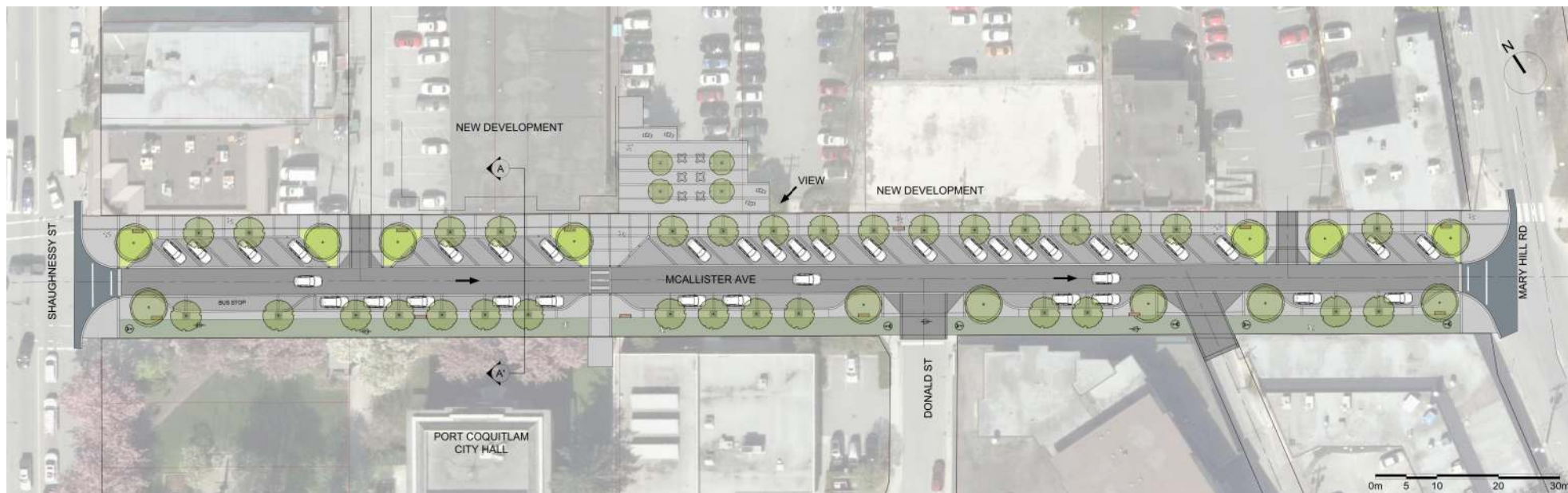

### OPTION 3 1-WAY, 1-SIDED ANGLED, 1-SIDED PARALLEL PARKING

- STREETSCAPE SUMMARY**
- ONE WAY VEHICLE TRAFFIC (EAST BOUND)
  - ANGLED PARKING NORTH SIDE, PARALLEL PARKING SOUTH SIDE
  - PARKING SPACES: 56
  - MULTI-USE PATH ON SOUTH SIDE, SIDEWALK ON NORTH SIDE
  - MID-BLOCK PEDESTRIAN CROSSING AND NEW PUBLIC PLAZA ON NORTH SIDE OF STREET
  - STREET TREES, BOLLARDS AND FURNISHINGS IN BOULEVARD SPACES

- POSITIVES**
- ACCOMMODATES ALL USERS
  - ENHANCED STREETSCAPE
  - NORTH SIDEWALK AND CAFE SPACES WELL BUFFERED FROM THE ROADWAY
  - LOW PARKING LOSS (2 STALLS)
  - OPPORTUNITIES FOR RAINGARDENS IN LARGE PLANTING BEDS

- NEGATIVES**
- TRAFFIC IMPACT (NO WEST BOUND TRAVEL)
  - NO WEST BOUND BUS TRAVEL OR STOP (EAST BOUND POSSIBLE WITH LOADING ON ROADWAY OR WITH STOP ABOVE AT VETERAN'S PARK)
  - BACK IN ANGLED PARKING UNFAMILIAR TO MANY DRIVERS
  - NARROWER BOULEVARD SPACES THAN OTHER STREETSCAPE OPTIONS

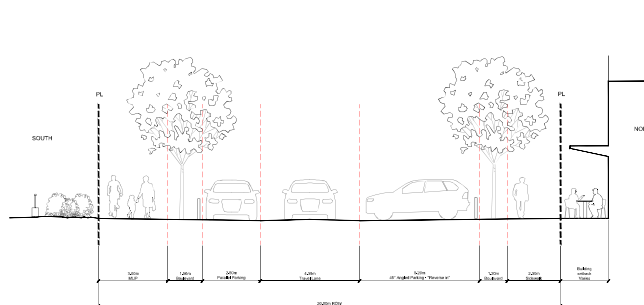

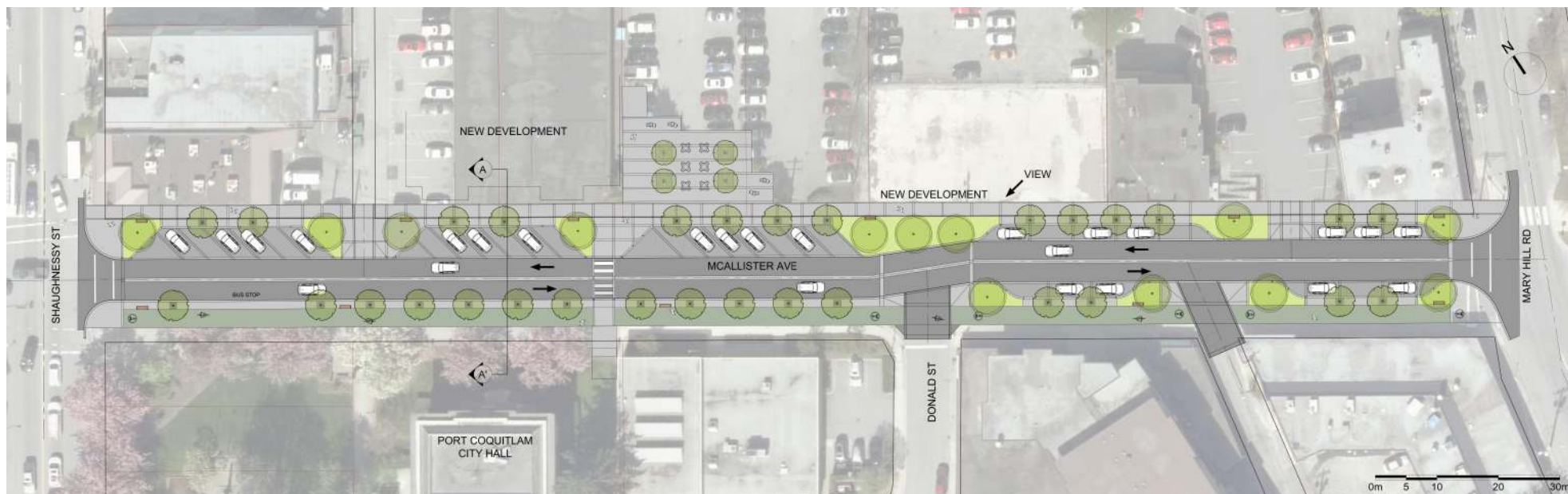

OPTION 4  
2-WAY, 1-SIDED ANGLED & 2-SIDED PARALLEL PARKING

## STREETSCAPE SUMMARY

- STREETSCAPE SUMMARY**
- TWO WAY VEHICLE TRAFFIC
  - ONE SIDED ANGLED PARKING NORTH SIDE BETWEEN SHAUGHNESSY ST AND DONALD ST, PARALLEL PARKING ON NORTH AND SOUTH SIDE FROM DONALD ST TO MARY HILL RD
  - PARKING SPACES: 33
  - MULTIPLE PATH ON SOUTH SIDE, SIDEWALK ON NORTH SIDE
  - MID-BLOCK PEDESTRIAN CROSSING AND NEW PUBLIC PLAZA ON NORTH SIDE OF STREET
  - STREET TREES, BOLLARDS AND FURNISHINGS IN BOULEVARD SPACES

## POSITIVES

- MINIMAL TRAFFIC IMPACT (MAINTAINS TWO WAY TRAVEL)
- ACCOMMODATES ALL USERS
- ENHANCED STREETScape
- NORTH SIDEWALK AND CAFE SPACES WELL BUFFERED FROM THE ROADWAY
- OPPORTUNITIES FOR RAINGARDENS IN LARGE PLANTING BEDS

- **NEGATIVES**

- **PARKING LOSS (23 FEWER SPACES THAN EXISTING NUMBER)**

